



# MSNST ITM LOAD CELL

## 1,000 – 15,000 LBS MODEL



### 1K–15K Integrated Tank Module Description:

The ITM offers a very low-profile design in a self-centering and self-checking assembly. Manufactured in 17-4 Stainless Steel. With a welded seal, the ITM is ideal for wash-down environments, as well chemical, food, and pharmaceutical applications.

The ITM is the way to weigh.

## SPECIFICATIONS



<b>Capacities</b>	1,000 – 15,000 <i>U.S. LBS</i>	
<b>Maximum Overload</b>	Safe: 150%	Ultimate: 300%
<b>Restraints</b>	Uplift: 100%	Lateral: 100%

<b>Construction</b>	17-4PH Stainless Steel + Heavy-Duty Polyurethane Cable <i>25'   4-Conductor   Shielded</i>
<b>Temperature Range</b>	0°F – 110°F

<b>Excitation Voltage</b>	10V – 15V <i>AC/DC</i>
<b>Output Configurations</b>	3mV/V ±0.1%
<b>Bridge Resistance</b>	350Ω <i>Input &amp; Output, ±1% ohms</i>
<b>Insulation Resistance</b>	5000 MΩ <i>min</i>

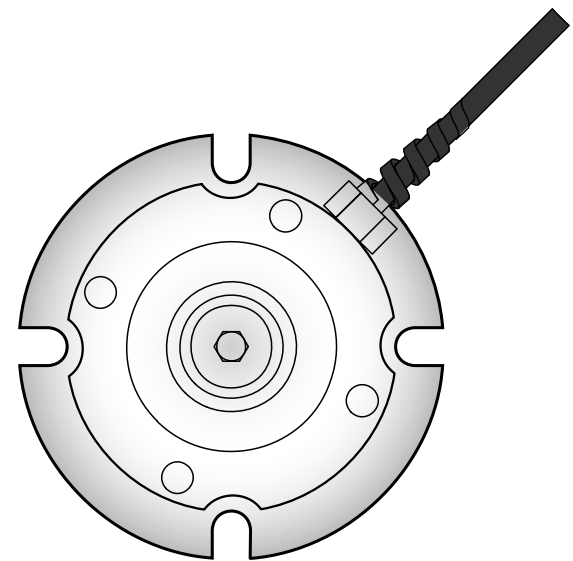

<b>Accuracy &amp; Precision</b>	Nonlinearity: 0.05%	Repeatability: 0.05%
	<i>Full-Scale Output</i>	<i>Full-Scale Output</i>

## WIRING SCHEMATIC

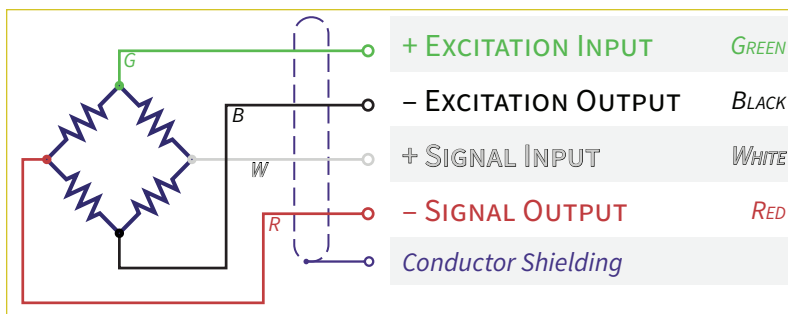

400°F high-temperature construction option available

Additional mounting plates optional.

See second page for dimensions.



# MSNST ITM LOAD CELL

## 1,000 – 15,000 LBS MODEL



### 1K – 15K | DIMENSIONS

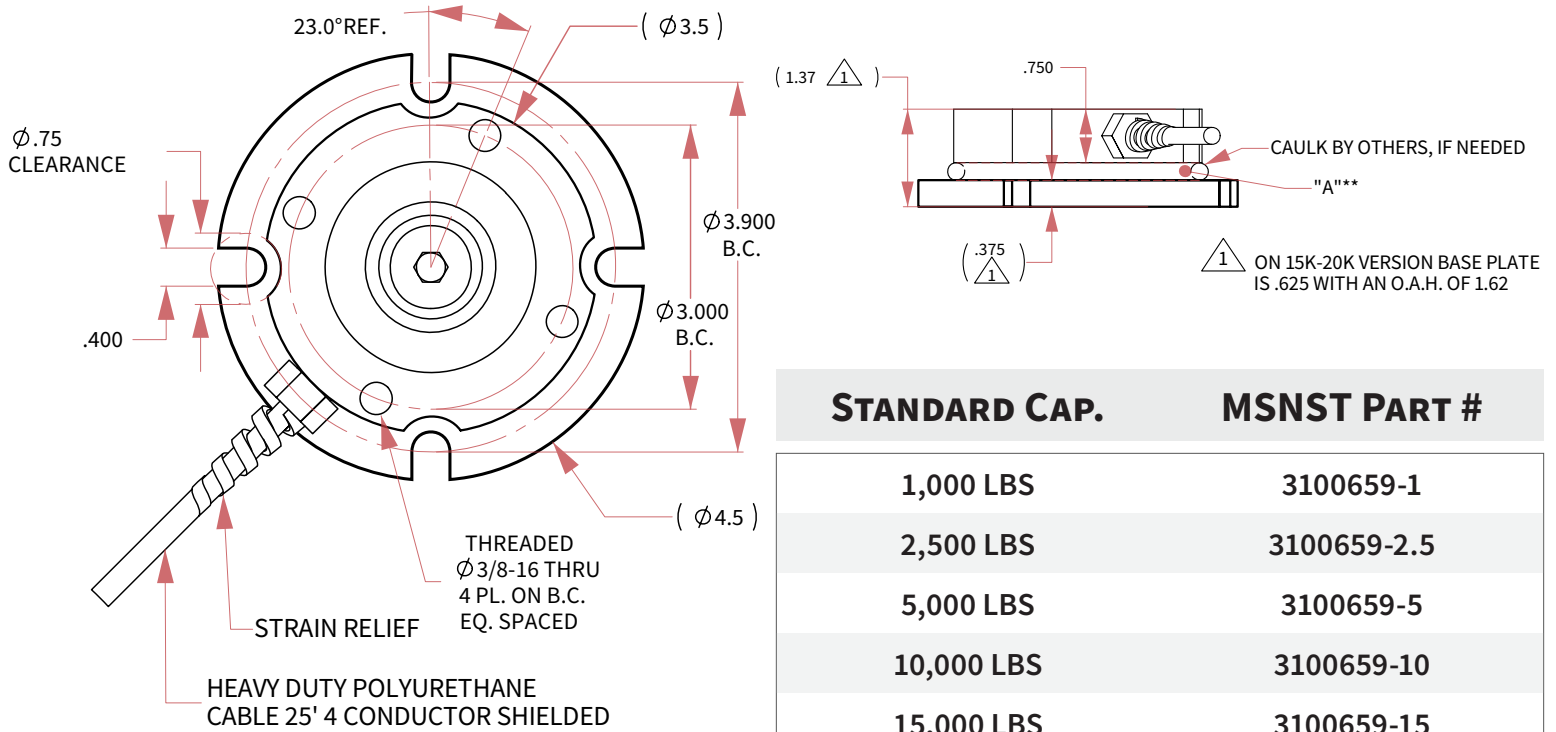

#### STANDARD CAP.

#### MSNST PART #

1,000 LBS	3100659-1
2,500 LBS	3100659-2.5
5,000 LBS	3100659-5
10,000 LBS	3100659-10
15,000 LBS	3100659-15

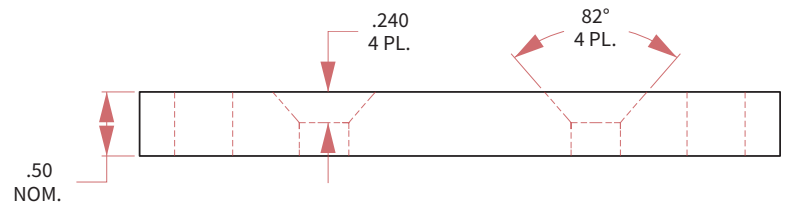
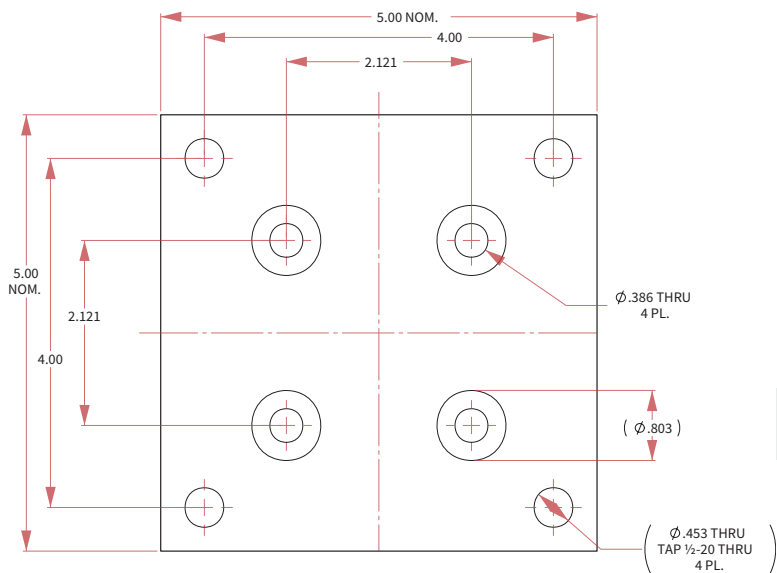

#### STANDARD CAP.

#### MSNST PART #

1K – 15K LBS	7200659
--------------	---------

Mounting assembly plates constructed in mild steel with painted coating by default.  
 For ordering plates in Stainless Steel: just add "-SS" after part number.



# MSNST ITM LOAD CELL

## 20,000 – 50,000 LBS MODEL



### 20K–50K Integrated Tank Module Description:

The ITM offers a very low-profile design in a self-centering and self-checking assembly. Manufactured in 17-4 Stainless Steel. With a welded seal, the ITM is ideal for wash-down environments, chemical, food, and pharmaceutical applications.

The ITM is the way to weigh.

## SPECIFICATIONS



<b>Capacities</b>	20,000 – 50,000 <i>U.S. LBS</i>	
<b>Maximum Overload</b>	Safe: 150%	Ultimate: 300%
<b>Restraints</b>	Uplift: 100%	Lateral: 100%

<b>Construction</b>	17-4PH Stainless Steel + Heavy-Duty Polyurethane Cable <i>25'   4-Conductor   Shielded</i>
<b>Temperature Range</b>	0°F – 110°F

<b>Excitation Voltage</b>	10V – 15V <i>AC/DC</i>
<b>Output Configurations</b>	2mV / V – 3mV / V ±0.1%
<b>Bridge Resistance</b>	350Ω <i>Input &amp; Output, ±1% ohms</i>
<b>Insulation Resistance</b>	5000 MΩ <i>min</i>

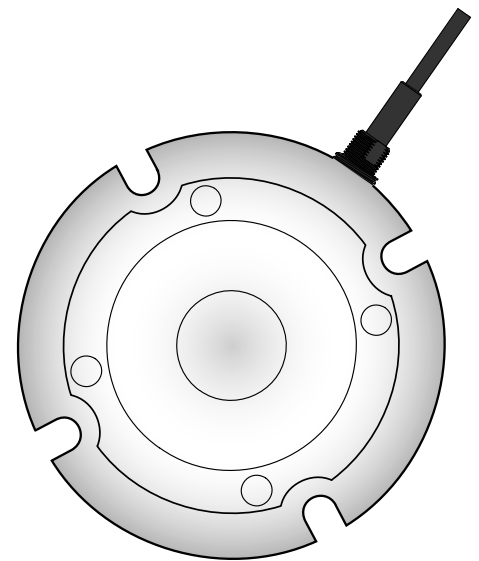

<b>Accuracy &amp; Precision</b>	Linearity: 0.05%	Repeatability: 0.02%
	<i>Full-Scale Output</i>	<i>Full-Scale Output</i>

## WIRING SCHEMATIC

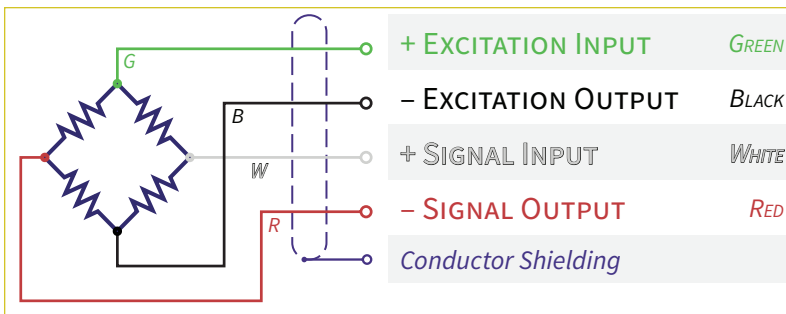

400°F high-temperature construction option available

Additional mounting plates optional.

See second page for dimensions.



# MSNST ITM LOAD CELL

## 20,000 – 50,000 LBS MODEL



### 20K – 50K | DIMENSIONS

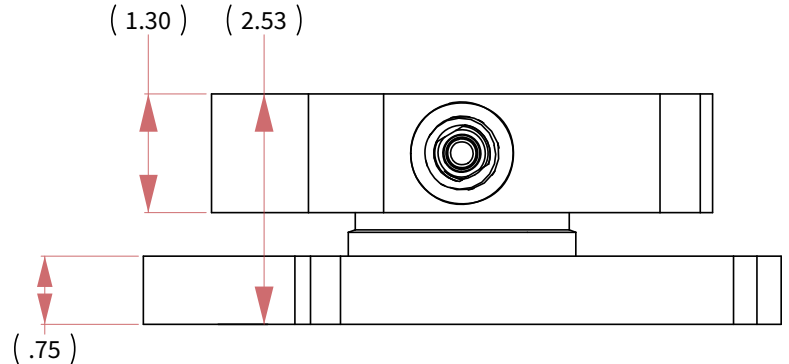
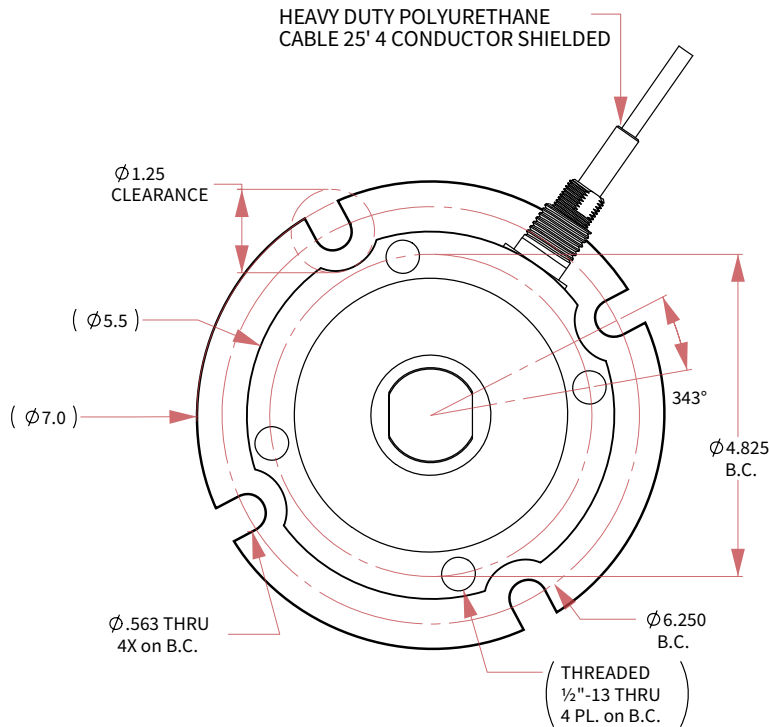

STANDARD CAP.	MSNST PART #
20,000 LBS	3100379-20
25,000 LBS	3100379-25
50,000 LBS	3100379-50

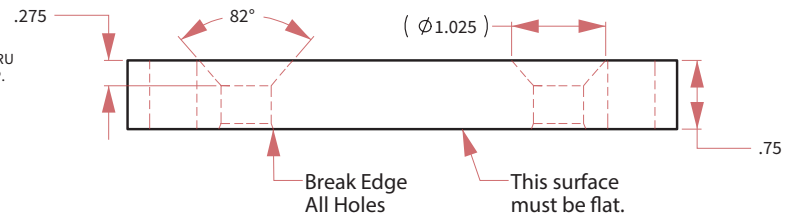
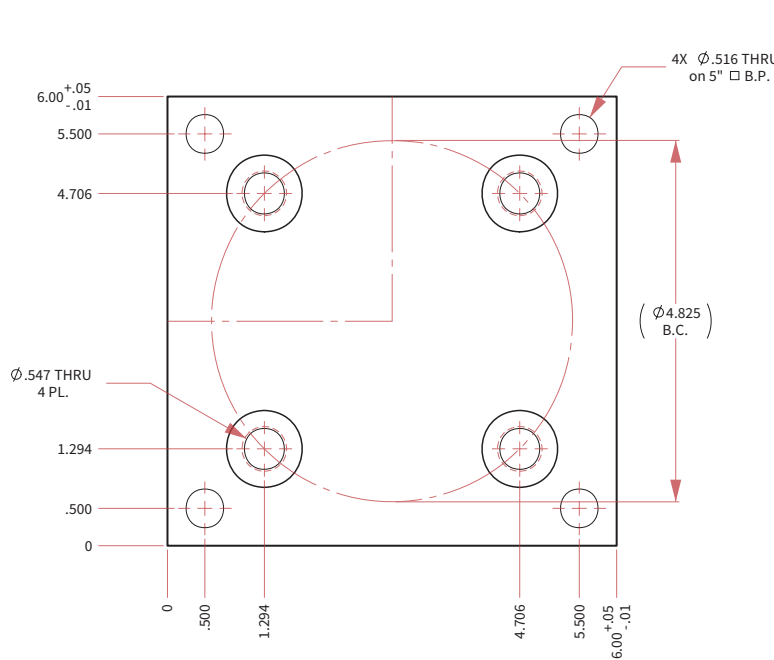

Note: Use 1/2"-13 F.H.C.S.  
2" long for attaching

STANDARD CAP.	MSNST PART #
20K – 50K LBS	8100749

Mounting assembly plates constructed in mild steel with painted coating by default.  
For ordering plates in Stainless Steel: just add "-SS" after part number.



# MSNST ITM LOAD CELL

## 60,000 – 125,000 LBS MODEL



### 60K–125K Integrated Tank Module Description:

The ITM offers a very low-profile design in a self-centering and self-checking assembly. Manufactured in 17-4 Stainless Steel. With a welded seal, the ITM is ideal for wash-down environments, chemical, food, and pharmaceutical applications.

The ITM is the way to weigh.

## SPECIFICATIONS

<b>Capacities</b>	60,000 – 125,000 U.S. LBS	
<b>Maximum Overload</b>	Safe: 150%	Ultimate: 300%
<b>Restraints</b>	Uplift: 100%	Lateral: 100%

<b>Construction</b>	17-4PH Stainless Steel + Heavy-Duty Polyurethane Cable 25'   4-Conductor   Shielded	
<b>Temperature Range</b>	0°F – 110°F	

<b>Excitation Voltage</b>	10V – 15V AC/DC	
<b>Output Configurations</b>	3mV/V ±0.1%	
<b>Bridge Resistance</b>	350Ω Input & Output, ±1% ohms	
<b>Insulation Resistance</b>	5000 MΩ min	

<b>Accuracy &amp; Precision</b>	Nonlinearity: 0.10%	Repeatability: 0.03%	Accommodations: ±0.2", ±3°
	Full-Scale Output	Full-Scale Output	Thermal & Non-Parallel

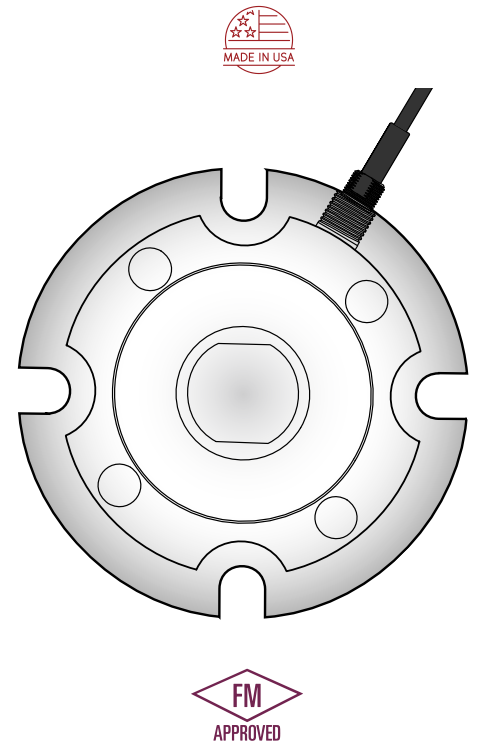

## WIRING SCHEMATIC

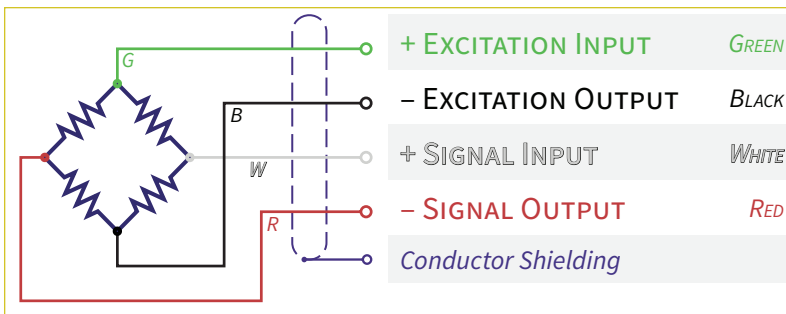

400°F high-temperature construction option available

Additional mounting plates optional.

See second page for dimensions.



# MSNST ITM LOAD CELL

## 60,000 – 125,000 LBS MODEL



### 60K – 125K | DIMENSIONS

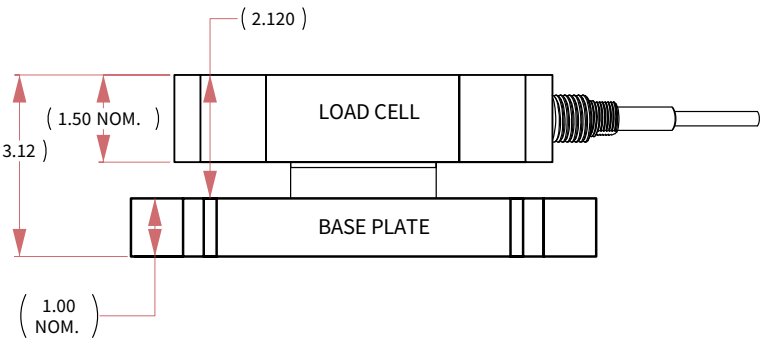
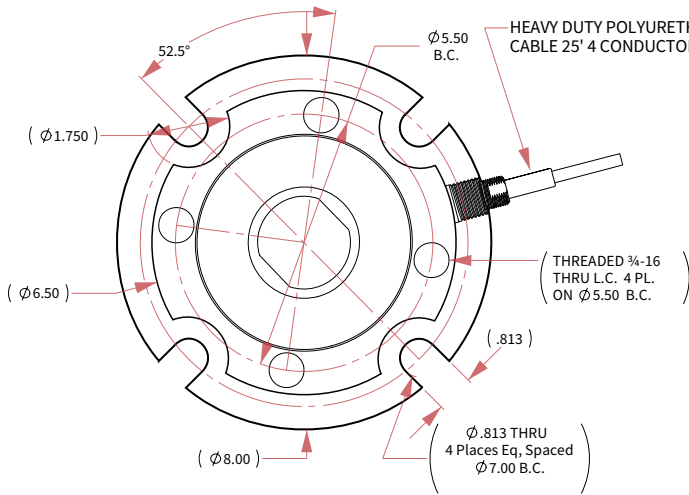

#### STANDARD CAP.

#### MSNST PART #

60,000 LBS	3500419-60
75,000 LBS	3500419-75
100,000 LBS	3500419-100
125,000 LBS	3500419-125

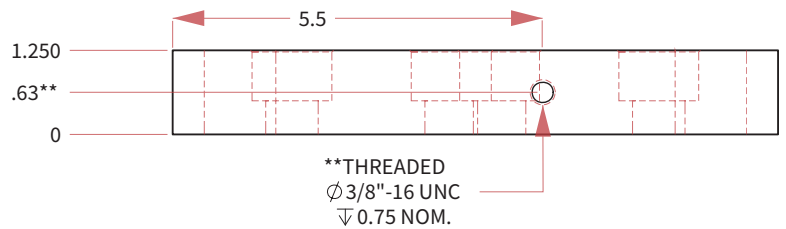
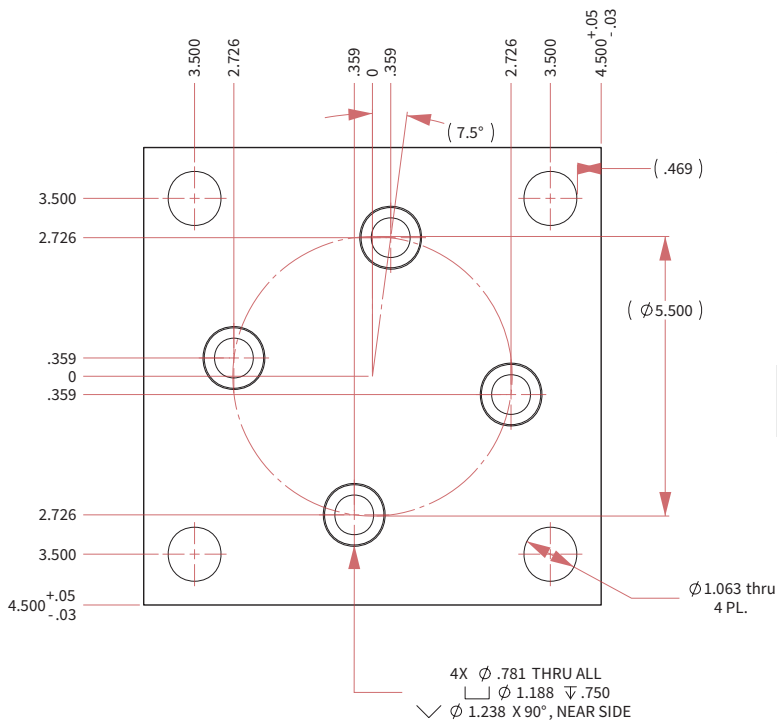

#### STANDARD CAP.

#### MSNST PART #

60K – 125K LBS	8400419
----------------	---------

Mounting assembly plates constructed in mild steel with painted coating by default.  
For ordering plates in Stainless Steel: just add"-SS"  
after part number.



# MSNST ITM LOAD CELL

## 150,000 – 225,000 LBS MODEL



### 150K–225K Integrated Tank Module Description:

The ITM offers a low-profile design in a self-centering and self-checking assembly. Manufactured in 17-4 Stainless Steel. With a welded seal, the ITM is ideal for wash-down environments, chemical, food, and pharmaceutical applications.

The ITM is the way to weigh.

## SPECIFICATIONS

<b>Capacities</b>	150,000 – 225,000 U.S. LBS	
<b>Maximum Overload</b>	Safe: 150%	Ultimate: 300%
<b>Restraints</b>	Uplift: 100%	Lateral: 100%

<b>Construction</b>	17-4PH Stainless Steel + Heavy-Duty Polyurethane Cable 25'   4-Conductor   Shielded
<b>Temperature Range</b>	0°F – 110°F

<b>Excitation Voltage</b>	10V – 15V AC/DC
<b>Output Configurations</b>	3mV/V ±0.1%
<b>Bridge Resistance</b>	350Ω Input & Output, ±1% ohms
<b>Insulation Resistance</b>	5000 MΩ min

<b>Accuracy &amp; Precision</b>	Nonlinearity: 0.10%	Repeatability: 0.03%	Accommodations: ±0.2", ±3°
	Full-Scale Output	Full-Scale Output	Thermal & Non-Parallel

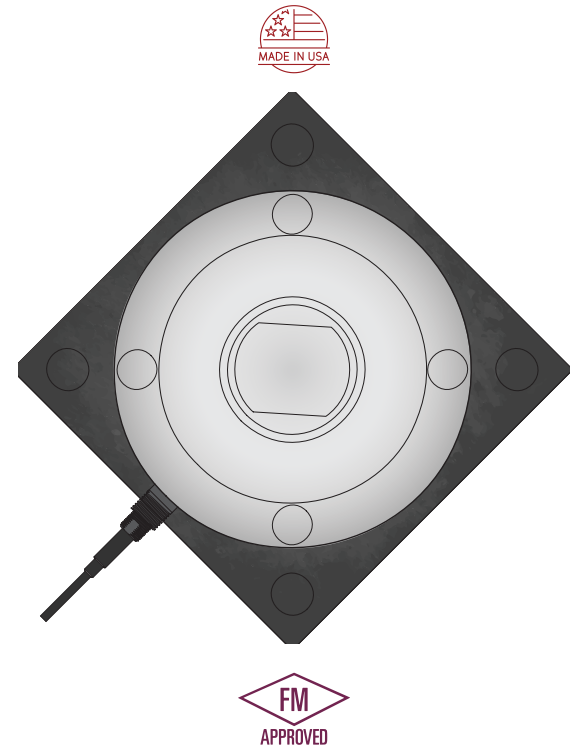

## WIRING SCHEMATIC

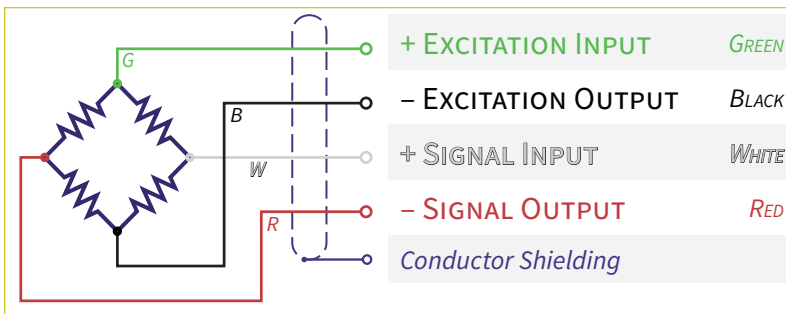

## Combined Error 0.10% Full-Scale Output

400°F high-temperature construction option available

Additional mounting plates optional.

See second page for dimensions.



# MSNST ITM LOAD CELL

## 150,000 – 225,000 LBS MODEL



### 150K – 225K | DIMENSIONS

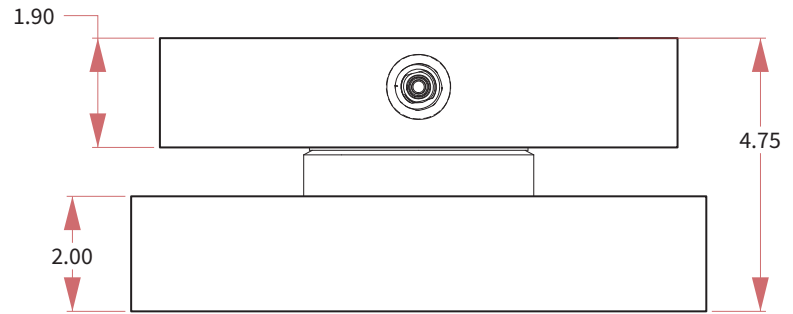
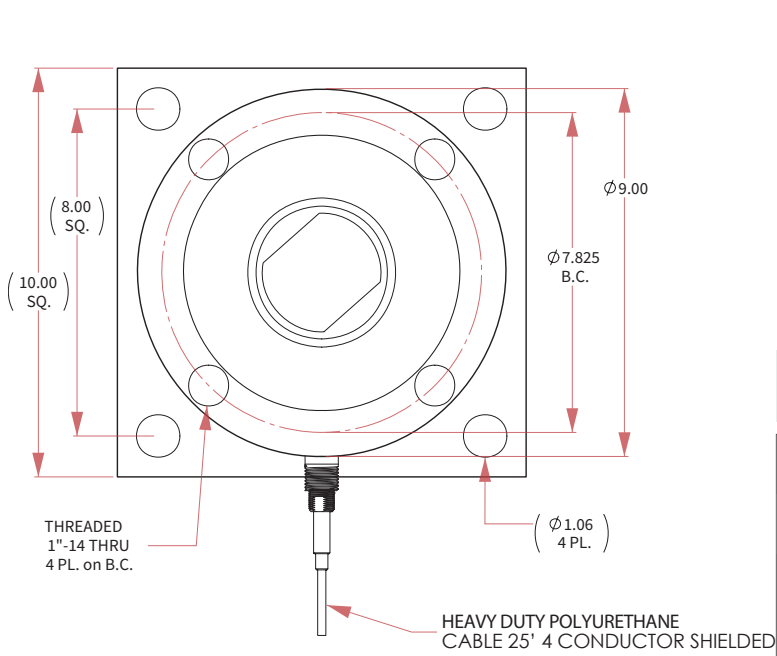

STANDARD CAP.	MSNST PART #
150,000 LBS	3500370-150
200,000 LBS	3500370-200
225,000 LBS	3500370-225

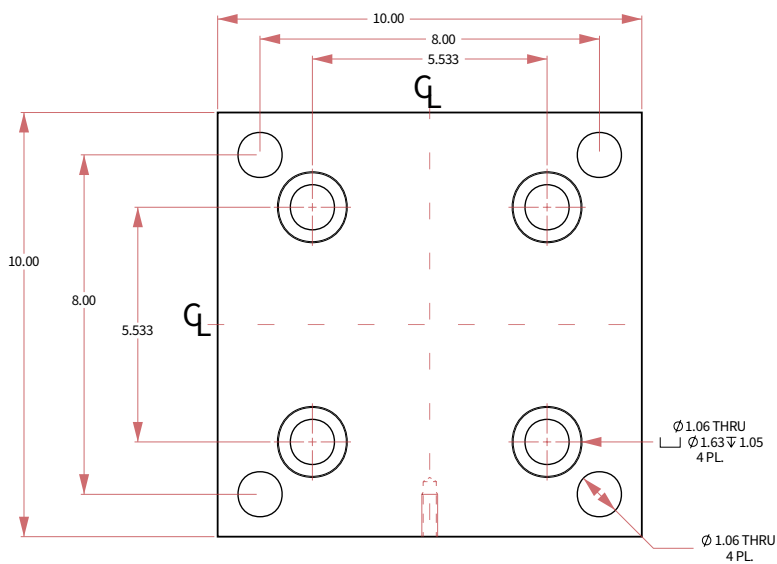

STANDARD CAP.	MSNST PART #
---------------	--------------

150K – 225K LBS 8300370

Bottom plates come with 150K – 225K LBS capacity load cells by default.

Additional plates or assemblies for units measuring above 200,000 LBS are manufactured on site, per job due to size, weight, & costs.

Mounting assembly plates constructed in mild steel with painted coating by default.

For ordering plates in Stainless Steel: just add "-SS" after part number.





# MSNST ITM LOAD CELL

## 250,000 – 450,000 LBS MODEL



### 250K–450K Integrated Tank Module Description:

The ITM offers a low-profile design in a self-centering and self-checking assembly. Manufactured in 17-4 Stainless Steel. With a welded seal, the ITM is ideal for wash-down environments, chemical, food, and pharmaceutical applications.

The ITM is the way to weigh.

## SPECIFICATIONS

<b>Capacities</b>	250,000 – 450,000 U.S. LBS	
<b>Maximum Overload</b>	Safe: 150%	Ultimate: 300%
<b>Restraints</b>	Uplift: 100%	Lateral: 100%

<b>Construction</b>	17-4PH Stainless Steel + Heavy-Duty Polyurethane Cable 25'   4-Conductor   Shielded
<b>Temperature Range</b>	0°F – 110°F

<b>Excitation Voltage</b>	10V – 15V AC/DC
<b>Output Configurations</b>	3mV/V ±0.1%
<b>Bridge Resistance</b>	350Ω Input & Output, ±1% ohms
<b>Insulation Resistance</b>	5000 MΩ min

<b>Accuracy &amp; Precision</b>	Nonlinearity: 0.10%	Repeatability: 0.03%	Accommodations: ±0.2", ±3°
	Full-Scale Output	Full-Scale Output	Thermal & Non-Parallel

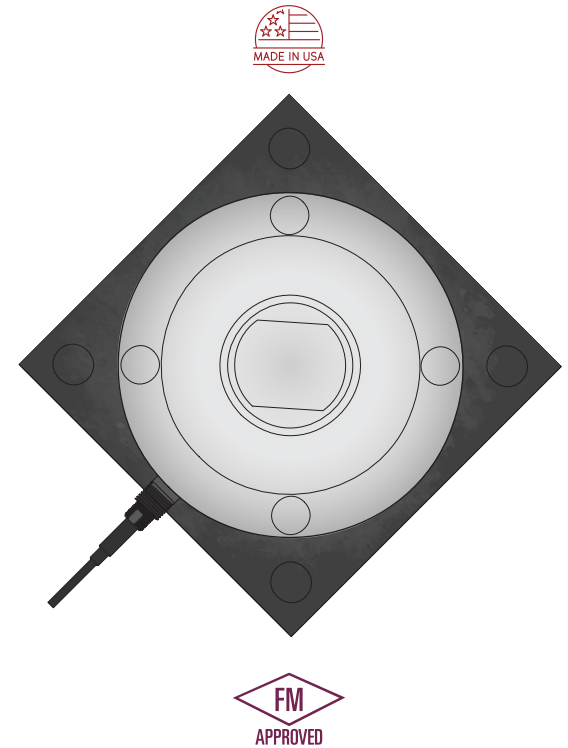

## WIRING SCHEMATIC

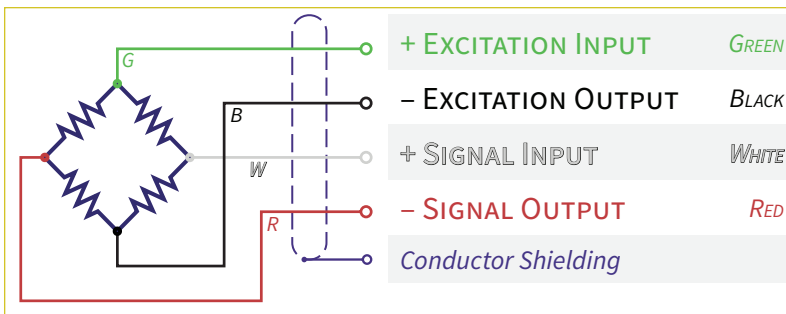

## Combined Error 0.10% Full-Scale Output

400°F high-temperature construction option available

Additional mounting plates optional.

See second page for dimensions.



# MSNST ITM LOAD CELL

## 250,000 – 450,000 LBS MODEL



### 250K – 450K | DIMENSIONS

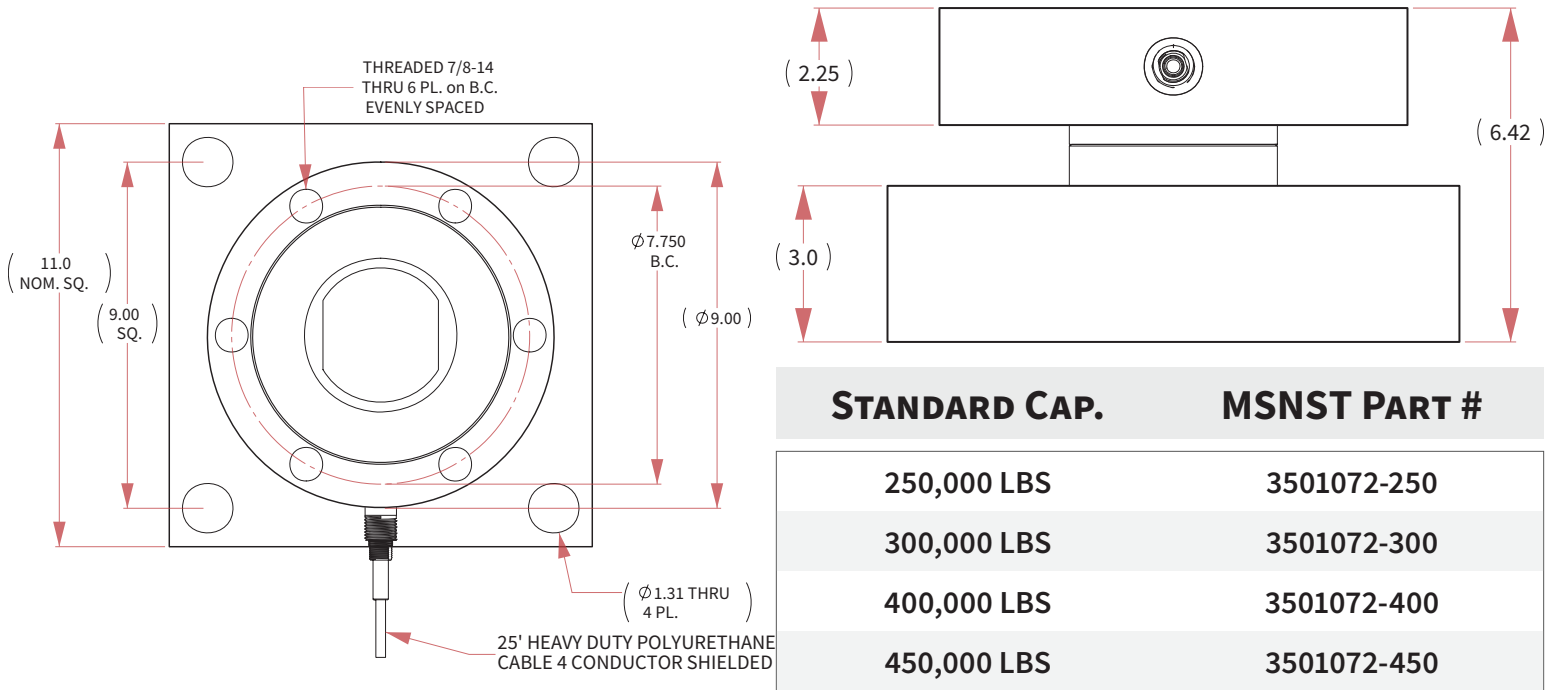

Bottom plates come with 250K – 450K LBS capacity load cells by default.

Additional plates or assemblies for units measuring above 200,000 LBS are manufactured on site, per job due to size, weight, & costs.

Mounting assembly plates constructed in mild steel with painted coating by default.

For ordering plates in Stainless Steel: just add "-SS" after part number.



# MSNST ITM LOAD CELL

## 500,000 – 1,100,000 LBS MODEL



### 500K–1,100K Integrated Tank Module Description:

The ITM offers a low-profile design in a self-centering and self-checking assembly. Manufactured in 17-4 Stainless Steel. With a welded seal, the ITM is ideal for wash-down environments, chemical, food, and pharmaceutical applications.

The ITM is the way to weigh.

## SPECIFICATIONS

<b>Capacities</b>	500,000 – 1,100,000 U.S. LBS	
<b>Maximum Overload</b>	Safe: 150%	Ultimate: 300%
<b>Restraints</b>	Uplift: 40%	Lateral: 40%

<b>Construction</b>	17-4PH Stainless Steel + Heavy-Duty Polyurethane Cable 25'   4-Conductor   Shielded
<b>Temperature Range</b>	0°F – 110°F

<b>Excitation Voltage</b>	10V – 15V AC/DC
<b>Output Configurations</b>	3mV/V ±0.1%
<b>Bridge Resistance</b>	350Ω Input & Output, ±1% ohms
<b>Insulation Resistance</b>	5000 MΩ min

<b>Accuracy &amp; Precision</b>	Nonlinearity: 0.05% Full-Scale Output	Repeatability: 0.01% Full-Scale Output	Accommodations: ±0.2", ±3° Thermal & Non-Parallel
---------------------------------	--	---	--



## WIRING SCHEMATIC

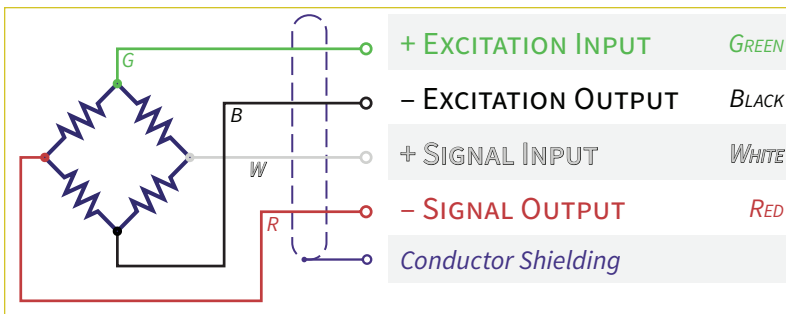

## Combined Error 0.10% Full-Scale Output



400°F high-temperature construction option available

Additional mounting plates optional.

See second page for dimensions.



# MSNST ITM LOAD CELL

## 500,000 – 1,100,000 LBS MODEL



### 500K – 1,100K | DIMENSIONS

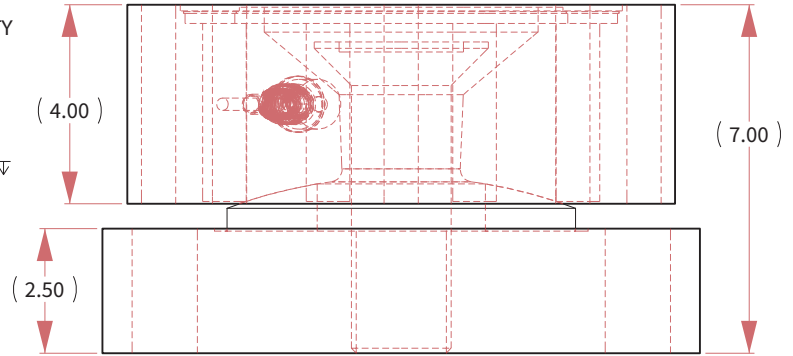
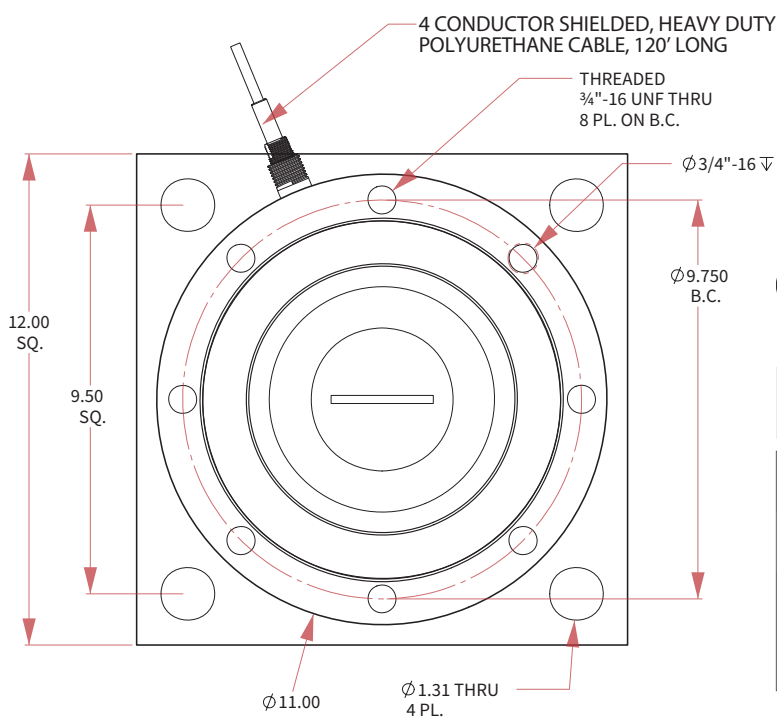

STANDARD CAP.	MSNST PART #
500,000 LBS	3100882-500
1,100,000 LBS	3100882-1100

Bottom plates come with 500K – 1,100K LBS capacity load cells by default.

Additional plates or assemblies for units measuring above 200,000 LBS are manufactured on site, per job due to size, weight, & costs.

Mounting assembly plates constructed in mild steel with painted coating by default.

For ordering plates in Stainless Steel: just add"-SS" after part number.